



## Cornwallis Gardens, Hastings TN34 1LX

Offers in excess of £200,000



A NEWLY REFURBISHED two bedroom apartment spanning the FIRST FLOOR of this period residence with attractive park views. It's enviably positioned in a central location within Hastings Town centre, just a short stroll from the beach, Alexandra Park, a range of local shops and a mainline railway station benefitting from connections to London stations. The accommodation is well presented throughout and enjoys GENEROUS PROPORTIONS, the living room measures an impressive 17'4 x 12'8 and features a large bay window framing a front aspect and there is a SEPARATE KITCHEN FITTED WITH CONTEMPORARY UNITS. There are two bedrooms, both benefitting from BUILT-IN STORAGE, together with a family bathroom where there is shower over the bath. Being sold with a share of freehold and NO ONWARD CHAIN this fantastic property would make the perfect first time home.

FIRST FLOOR  
739 sq.ft. (68.7 sq.m.) approx.

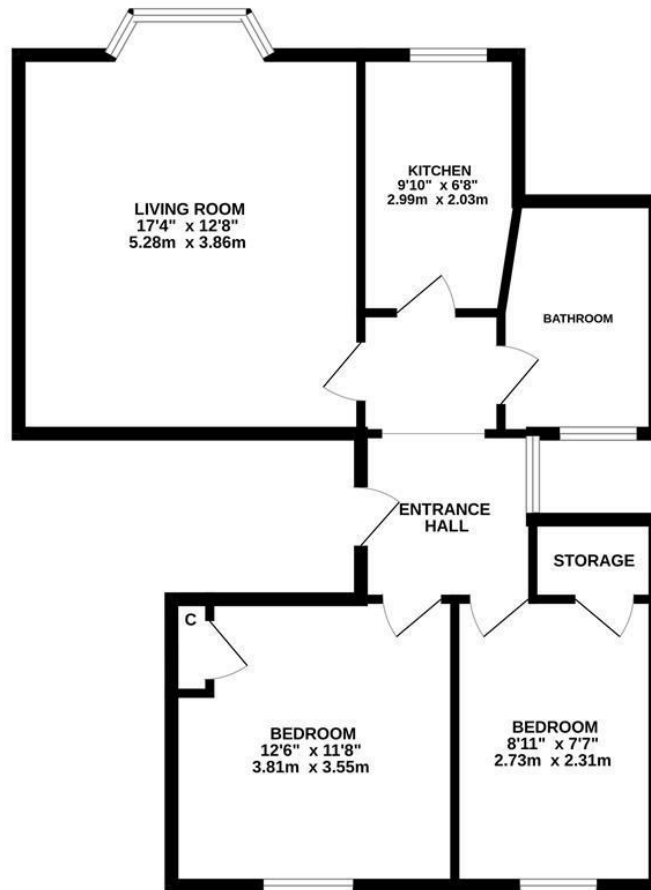

TOTAL FLOOR AREA : 739 sq.ft. (68.7 sq.m.) approx.

Whilst every attempt has been made to ensure the accuracy of the floorplan contained here, measurements of doors, windows, rooms and any other items are approximate and no responsibility is taken for any error, omission or mis-statement. This plan is for illustrative purposes only and should be used as such by any prospective purchaser. The services, systems and appliances shown have not been tested and no guarantee as to their operability or efficiency can be given.  
Made with Metropix ©2025.

